

QJS RANGE

Noise Controlled Jolt Squeeze, Moulding Machines

QJS 214 / 217 / 219 / 222 / 226 / 230 / 240 Automatics
QJS 214 Manual

Special Features:

- Noise Controlled
- Combined Jolt Squeeze
- Accurate Centreline Draw
- Variable Jolt Timers
- Operational Roller or Pin Lift Draw
- Operational Safety Guards
- Operational Pneumatic, Electrical or Microprocessor Control.



Overall Dimensions QJS Range

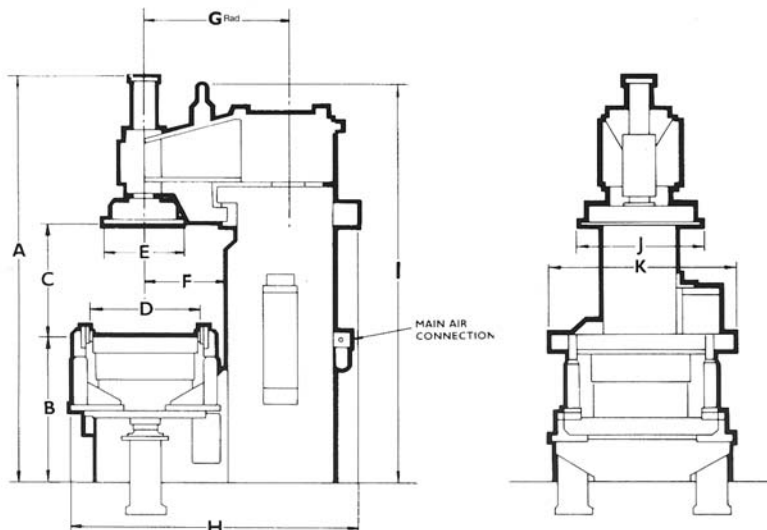

	QJSM 214		QJS 214		QJS 217		QJS 219		QJS 222		QJS 226		QJS 230		QJS 240	
	mm	in	mm	in	mm	in	mm	in	mm	in	mm	in	mm	in	mm	in
A	1800	71	1800	71	2030	80	2230	87½	2515	99	3335	131¼	3730	147	5085	200
B	737	29	737	29	750	29½	800	31½	880	34¾	1117	44	1295	51	1670	65¼
C MAX	509	20	509	20	584	23	660	26	762	30	946	37¼	1030	40½	1430	56¼
C MIN	230	9	230	9	330	13	405	16	508	20	590	23¼	622	24½	813	32
D MAX	594	23¾	594	23¾	854	33¼	945	37¼	1092	43	1245	49	1355	53¼	1615	63½
D MIN	455	17⅞	455	17⅞	595	23½	620	24½	755	29¾	830	32¼	1005	39½	1530	60¼
E	356	14	356	14	434	17	510	20	560	22	610	24	710	28	13001	51¼
F	356	14	356	14	485	19	535	21	610	24	685	27	762	30	1020	40⅞
G	490	19¼	490	19¼	800	31½	880	34¾	987	38¾	1180	46½	1295	51	1745	68¾
H	1155	45 ½	1230	48 ½	1770	69¾	2195	86½	2440	96	2735	107¾	2985	117½	3845	151½
I	1750	69	1750	69	2190	86¼	2395	94¼	2620	103¼	3225	127	3645	143½	NOT APPLICABLE SEE DIMENSION "A"	
J	356	14	356	14	560	22	710	28	760	30	915	36	1065	42	1760	69¼
K	865	34	865	34	1160	45¾	1305	21½	1485	58¾	1450	57½	1675	66	2380	93¾

TECHNICAL DATA

	QJSM 214	QJS 214	QJS 217	QJS 219	QJS 222	QJS 226	QJS 230	QJS 240
Jolt Capacity*	455 kg 1000 lb	455 kg 1000 lb	680 kg 1500 lb	1135 kg 2500 lb	1590 kg 3500 lb	2040 kg 4500 lb	2720 kg 6000 lb	4080 kg 9000 lb
Static Squeeze Force*	6280 kg 13850 lb	6280 kg 13850 lb	9260 kg 20420 lb	11570 kg 25500 lb	15520 kg 34200 lb	21670 kg 47800 lb	28850 kg 63600 lb	51300 kg 113100 lb
Dynamic Squeeze Force*	11000 kg 24240 lb	11000 kg 24240 lb	16200 kg 35700 lb	20250 kg 44650 lb	27150 kg 59850 lb	37950 kg 83650 lb	50500 kg 111300 lb	89750 kg 197900 lb
Squeeze Stroke	135 mm 5 ¼ in	135 mm 5 ¼ in	180 mm 7 in	230 mm 9 in	255 mm 10 in	280 mm 11 in	305 mm 12 in	460 mm 24 in
Pattern Draw	180 mm 7 in	180 mm 7 in	305 mm 12 in	355 mm 14 in	405 mm 16 in	405 mm 16 in	405 mm 16 in	610 mm 24 in
Table Size Roller-lift**	750x420mm 29½ x16½	750x420mm 29½ x16½	840x560mm 33x22 in	920x585mm 36¼x23 in	1065x700mm 42x27½ in	1170x755mm 46x30½	1270x940mm 50x37 in	1850x1250mm 73x49¼ in

*Jolt capacity and static squeeze pressure calculated at 90 psi (6.1 atu).

**Static squeeze pressure increase by approximately 100% during simultaneous jolt squeezes.

FREE AIR CONSUMPTION

	QJSM 214	QJS 214†	QJS 217	QJS 219	QJS 222	QJS 226	QJS 230	QJS 240
Average per cycle	0.51 m ³ 18 ft ³	0.79 m ³ 28 ft ³	0.99 m ³ 35 ft ³	1.05 m ³ 37 ft ³	1.22 m ³ 43 ft ³	1.73 m ³ 61 ft ³	2.69 m ³ 95 ft ³	5.94 m ³ 210 ft ³

SHIPPING SPECIFICATIONS

	QJSM 214	QJS 214	QJS 217	QJS 219	QJS 222	QJS 226	QJS 230	QJS 240
Net Weight	1222 kg 2693 lb	1237kg41kg 2762lb 90lb	3709 kg 8175 lb	5334 kg 11756 lb	6858 kg 15115 lb	8790 kg 19373 lb	13375 kg 29479 lb	***
Gross Weight	1354 kg 2984 lb	1452 150kg 3200lb 331l	4075 kg 8981 lb	5603 kg 12349 lb	7454 kg 16429 lb	9550 kg 21048 lb	14530 kg 32024 lb	***
Case Size	2.59 cu.m. 92 cu.ft.	2.69 0.83 cu.m. 94.5 29.0 cu.ft.	5.5 cu.m. 195 cu.ft.	7.1 cu.m. 251 cu.ft.	10.98 cu.m. 387.3 cu.ft.	16.67 cu.m. 591 cu.ft.	16.72 cu.m. 589.5 cu.ft.	***

***Subject to specification

†Packed in to separate cases.

BMM WESTON

BMM WESTON Limited
Faversham,
Kent,
ME13 7EB, ENGLAND

<http://www.bmmweston.com>

Telephone: +44 (0) 1795 533441

Facsimile: +44 (0) 1795 538891

BMM Weston reserves the right to alter the specification contained in this leaflet without prior notice.